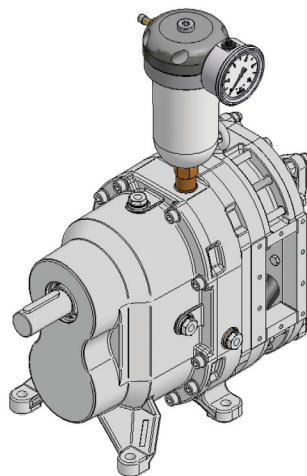

# VX100-45Q

**VOGELSANG**

The VX Series is our advanced line of pumps. You'll find VX pumps in many applications in agriculture, industry and municipalities. To minimize wear and maximize performance these pumps feature design innovations that you can only get from Vogelsang such as HiFlo Lobes, Blocking Cartridge Seals and adjustable housing segments.

## HIFLO POSITIVE DISPLACEMENT ROTARY LOBE PUMPS

**Run Dry Without Damage:** Vogelsang pumps are warranted against damage from run dry for a period up to 30 minutes.

**Complete Wet-End Rebuilds Inline:** Change rotors, mechanical seals, lip seals, wear plates, and adjust housing segments with ease.

**100% Pulsation Free Operation:** Vogelsang HiFlo Rotors provide pulsation free operation through the entire range of pumping.

**Maximum Mechanical Seal Life:** Vogelsang pumps use a pressurized oil canister to maintain pressure inside a buffer chamber between the wetend and gear box. This pressure reduces the wear on the mechanical seals and help keep your pump at optimum performance.

**Self Priming to 25' (Wet):** With suction lifts to 25', Vogelsang pumps excel at the toughest suction lift applications.

**Compact Size Reduces Expense:** Small footprints equate to reduced construction and fabrication expense.

**Unlimited Drive Options:** V-Belt drives, Geared Motors with reducers, Close coupled hydraulic motors, air or submersible, Power Take Off. Vogelsang pumps offer unlimited drive options.

**Low Noise Operation:** Just 78db at 3 feet.

**Excellent for Shear Sensitive Material:** Our gentle pumping action coupled with 100% pulsation free operation makes Vogelsang the pump of choice for all your shear sensitive material pumping needs.

## MECHANICAL SPECIFICATIONS: STANDARD & OPTIONAL

### Materials:

**Bearing Housing:** Gray Cast Iron (230-260 Brinell)

**Front Cover:** Gray Cast Iron (230-260 Brinell)

**Front & Rear Wear Plate Options:** Hardox (700 Brinell), Optional: Tungsten Carbide, Stainless Steel.

**Pump Shaft:** Carbon Steel (ASTM A470)

**Shaft Sleeve:** Stellite Coated Stainless Steel.

**Housing Segment Options:** Gray Cast Iron (750 Brinell), Optional: Tungsten Carbide, Stainless Steel.

**Mechanical Seal Options:** Component Seal, Duronite or Silicon Carbide. Block Ring Cartridge Seal, Duronite or Silicon Carbide.

**Rotor Core:** Gray Cast Iron

**Rotor Coating Options:** SBR, NBR (standard in new pumps), SewageLine, Viton, Werobust, Steel, Stainless Steel.

### Mechanical Specifications:

**Connections:** Suction, 2.5" Discharge, 2.5"

**Weight:** 114lbs.

**Mounting & Drive Options:** Inline Gear Motor, Piggy-Back V-belt, Hydraulic, PTO.

**Housing Segment Options:** Standard

### Warranty, Testing & Quality Assurance:

**Warranty:** Municipal, 2 years, 100% parts and labor, including wear. Industrial & Agricultural, 1 year, manufacturer's defects.

**Testing:** Each pump is factory tested at the customers specified duty point at a suitable range of flow and pressure conditions in accordance with Hydraulic Institute Standards.

**ISO 9001:2008 Certification:** Vogelsang is a fully certified for the manufacture and repair of industrial pumping equipment.

# VX100-45Q



## PERFORMANCE SPECIFICATIONS

Series & Model	Capacity gpm	Capacity m <sup>3</sup> /h	Displacement gal/100rev	Displacement l/100rev	Max Solids in mm	flange Size in mm	Max Pressure Q: psi bar	Max Speed rpm 1/min
VX100-45Q	13-60	3-13	7.7	29	.75 20	2.5 65	145 10	1000

## PERFORMANCE CURVES

lobe coating: NBR-HiFlo  
starting torque: 247 in lb

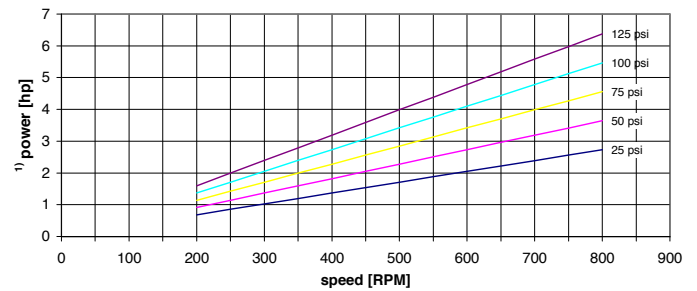
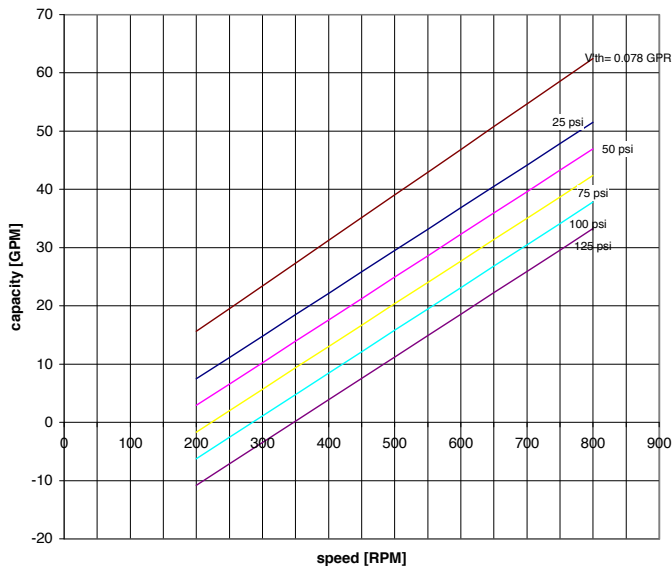

Values based upon water 70°F

1) required driving power at the pump shaft

## DIMENSIONAL DRAWING

All dimensions in inches  
except shaft diameter

